

M3 Junction 9 Improvement

Scheme Number: TR010055

2.12 Drainage and Surface Water Plans (Rev 1)

APFP Regulations 5(2)(o)

Planning Act 2008

**Infrastructure Planning (Applications: Prescribed Forms and
Procedure) Regulations 2009**

Volume 2

15 June 2023



NOTES
 Purpose of use
APPLICATION SUBMISSION
 Development Consent Order Number / Document
 TR010055/2.12

1. THIS DRAWING HAS BEEN PRODUCED USING CAD SOFTWARE. THEREFORE ALL DIMENSIONS ARE SHOWN IN METRES UNLESS SHOWN OTHERWISE.
 2. DO NOT SCALE FROM THIS DRAWING. USE ONLY PRINTED DIMENSIONS.

KEY TO SYMBOLS
 — DEVELOPMENT CONSENT ORDER BOUNDARY

REV	DATE	REVISION NOTE	ORIG	CHKD	APPD
0	NOVEMBER 2022	APPLICATION SUBMISSION	GP	LC	MF

DESIGNER

CONTRACTOR

CLIENT

PROJECT TITLE
 M3 JUNCTION 9 IMPROVEMENT SCHEME

PROJECT STAGE
 PCF STAGE 3

DRAWING TITLE
 DRAINAGE & SURFACE WATER PLANS
 APPP REGULATION 5(2)(a)
 KEY PLAN
 DOCUMENT REFERENCE: 2.12

SUITABILITY
 APPLICATION SUBMISSION

SHEET SIZE: A1 SCALE: 1:12,500 STATUS: REV 0
 DRAWING NUMBER
 HES51511-VFK-LSI-X_XXXX_XX-DR-ZL-7000

© Crown copyright and database rights 2022. Use of this data is subject to terms and conditions. Ordnance Survey Licence 100030649.



BASINGSTOKE

M3

PRIVATE FARM TRACK

PRIVATE FARM TRACK

FOR CONTINUATION SEE SHEET 2 OF 10

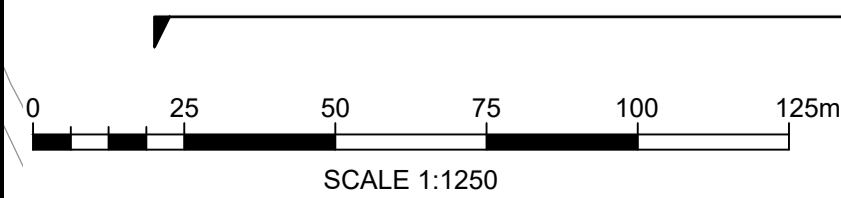

NOTES

Purpose of use
APPLICATION SUBMISSION

Development Consent Order Number / Document
TR010055/2.12

- THIS DRAWING HAS BEEN PRODUCED USING CAD SOFTWARE. THEREFORE ALL DIMENSIONS ARE SHOWN IN METRES UNLESS SHOWN OTHERWISE.
- DO NOT SCALE FROM THIS DRAWING. USE ONLY PRINTED DIMENSIONS.
- THE DESIGN SHOWN WILL BE SUBJECT TO DETAILED DESIGN DEVELOPMENT IN ACCORDANCE WITH THE PROVISIONS OF THE DEVELOPMENT CONSENT ORDER.

- KEY TO SYMBOLS
- DEVELOPMENT CONSENT ORDER BOUNDARY
 - LAND NOT INCLUDED IN ORDER LIMITS
 - PROPOSED ROAD MARKINGS
 - PROPOSED HIGHWAY DRAINAGE NETWORK
 - RETAINED EXISTING DRAINAGE NETWORK
 - RIVER ITCHEN
 - PROPOSED SURFACE WATER GEOCELLULAR ATTENUATION
 - PROPOSED SURFACE WATER INFILTRATION BASIN
 - PROPOSED SURFACE WATER LINED BASIN
 - PROPOSED SURFACE WATER SWALE
 - PROPOSED AREA OF NEW CARRIAGEWAY
 - RETAINED EXISTING CARRIAGEWAY AND ASSOCIATED DRAINAGE FEATURES
 - U PROPOSED SURFACE WATER HEADWALL / OUTFALL
 - PS PROPOSED SURFACE WATER PENSTOCK
 - PROPOSED SURFACE WATER SEDIMENT FOREBAY
 - ⊗ EXISTING SURFACE WATER SOAKAWAY FEATURE TO BE REFURBISHED AND REUSED
 - FC PROPOSED SURFACE WATER FLOW CONTROL MANHOLE
 - ∇ PROPOSED GRASSED BASINS
 - X-X- EXISTING INFILTRATION FEATURE TO BE ABANDONED

NOTE:
EXACT FORM OF DRAINAGE REQUIRED TO COLLECT SURFACE WATER RUN OFF (E.G. GULLIES, FILTER DRAINS, CONCRETE CHANNELS) WILL BE DETERMINED AT DETAILED DESIGN

01	JUNE 2023	DEADLINE 2	EO	LC	MF
0	NOVEMBER 2022	APPLICATION SUBMISSION	GP	LC	MF
REV	DATE	REVISION NOTE	ORIG	CHKD	APPD

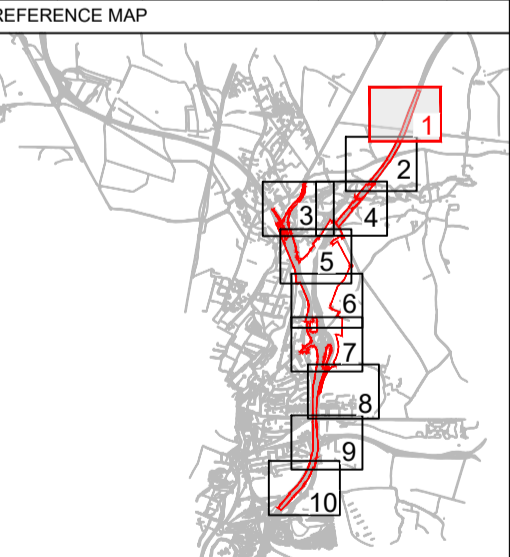

DESIGNER

CONTRACTOR

CLIENT

PROJECT TITLE
M3 JUNCTION 9 IMPROVEMENT SCHEME

PROJECT STAGE
PCF STAGE 3

DRAWING TITLE
DRAINAGE & SURFACE WATER PLANS
APFP REGULATION s(2)(a)
SHEET 1 OF 10
DOCUMENT REFERENCE: 2.12

SUITABILITY
APPLICATION SUBMISSION

SHEET SIZE: A1 SCALE: 1:1,250 STATUS: REV 01
DRAWING NUMBER
HES51511-VFK-LSI-X_XXXX_XX-DR-ZL-7001



FOR CONTINUATION SEE SHEET 1 OF 10

NOTES

Purpose of use
APPLICATION SUBMISSION

Development Consent Order Number / Document
TR010055/2.12

1. THIS DRAWING HAS BEEN PRODUCED USING CAD SOFTWARE. THEREFORE ALL DIMENSIONS ARE SHOWN IN METRES UNLESS SHOWN OTHERWISE.

2. DO NOT SCALE FROM THIS DRAWING. USE ONLY PRINTED DIMENSIONS.

3. THE DESIGN SHOWN WILL BE SUBJECT TO DETAILED DESIGN DEVELOPMENT IN ACCORDANCE WITH THE PROVISIONS OF THE DEVELOPMENT CONSENT ORDER.

- KEY TO SYMBOLS
- DEVELOPMENT CONSENT ORDER BOUNDARY
 - LAND NOT INCLUDED IN ORDER LIMITS
 - PROPOSED ROAD MARKINGS
 - PROPOSED HIGHWAY DRAINAGE NETWORK
 - RETAINED EXISTING DRAINAGE
 - RIVER ITCHEN
 - PROPOSED SURFACE WATER GEOCELLULAR ATTENUATION
 - PROPOSED SURFACE WATER INFILTRATION BASIN
 - PROPOSED SURFACE WATER LINED BASIN
 - PROPOSED SURFACE WATER SWALE
 - PROPOSED AREA OF NEW CARRIAGEWAY
 - RETAINED EXISTING CARRIAGEWAY AND ASSOCIATED DRAINAGE FEATURES
 - U PROPOSED SURFACE WATER HEADWALL / OUTFALL
 - PS PROPOSED SURFACE WATER PENSTOCK
 - PROPOSED SURFACE WATER SEDIMENT FOREBAY
 - EXISTING SURFACE WATER SOAKAWAY FEATURE TO BE REFURBISHED AND REUSED
 - FC PROPOSED SURFACE WATER FLOW CONTROL MANHOLE
 - v PROPOSED GRASSED BASINS
 - x-x- EXISTING INFILTRATION FEATURE TO BE ABANDONED

NOTE:
 EXACT FORM OF DRAINAGE REQUIRED TO COLLECT SURFACE WATER RUN OFF (E.G. GULLIES, FILTER DRAINS, CONCRETE CHANNELS) WILL BE DETERMINED AT DETAILED DESIGN

01	JUNE 2023	DEADLINE 2	EO	LC	MF
0	NOVEMBER 2022	APPLICATION SUBMISSION	GP	LC	MF
REV	DATE	REVISION NOTE	ORIG	CHKD	APPD

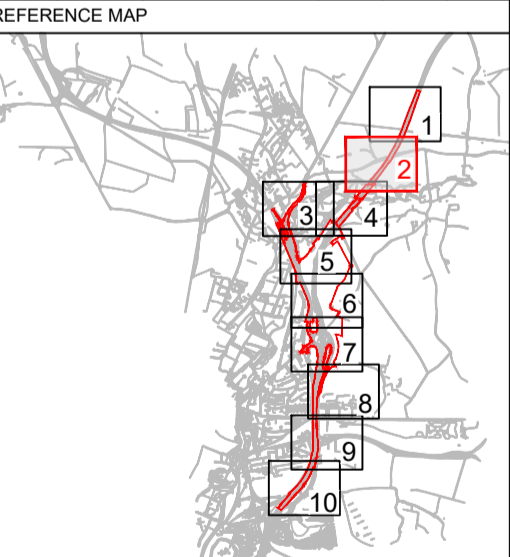

DESIGNER

CONTRACTOR

CLIENT

PROJECT TITLE
M3 JUNCTION 9 IMPROVEMENT SCHEME

PROJECT STAGE
PCF STAGE 3

DRAWING TITLE
**DRAINAGE & SURFACE WATER PLANS
 APPFP REGULATION s(2)(a)
 SHEET 2 OF 10
 DOCUMENT REFERENCE: 2.12**

SUITABILITY
APPLICATION SUBMISSION

SHEET SIZE: A1 SCALE: 1:1,250 STATUS: REV 01
 DRAWING NUMBER
 HES51511-VFK-LSI-X_XXXX_XX-DR-ZL-7002

ABBOTS WORTHY

B3047

M3

B3047

B3047

RIVER ITCHEN

RIVER ITCHEN

FOR CONTINUATION SEE SHEET 4 OF 10

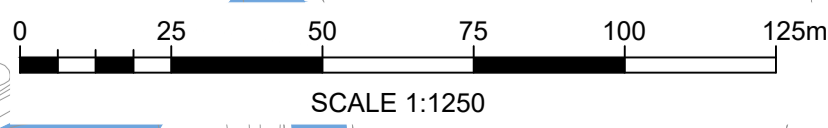

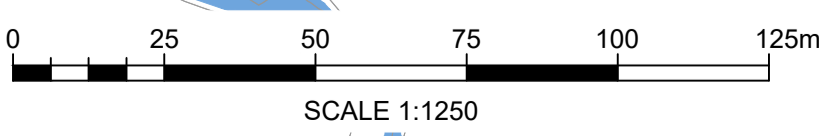
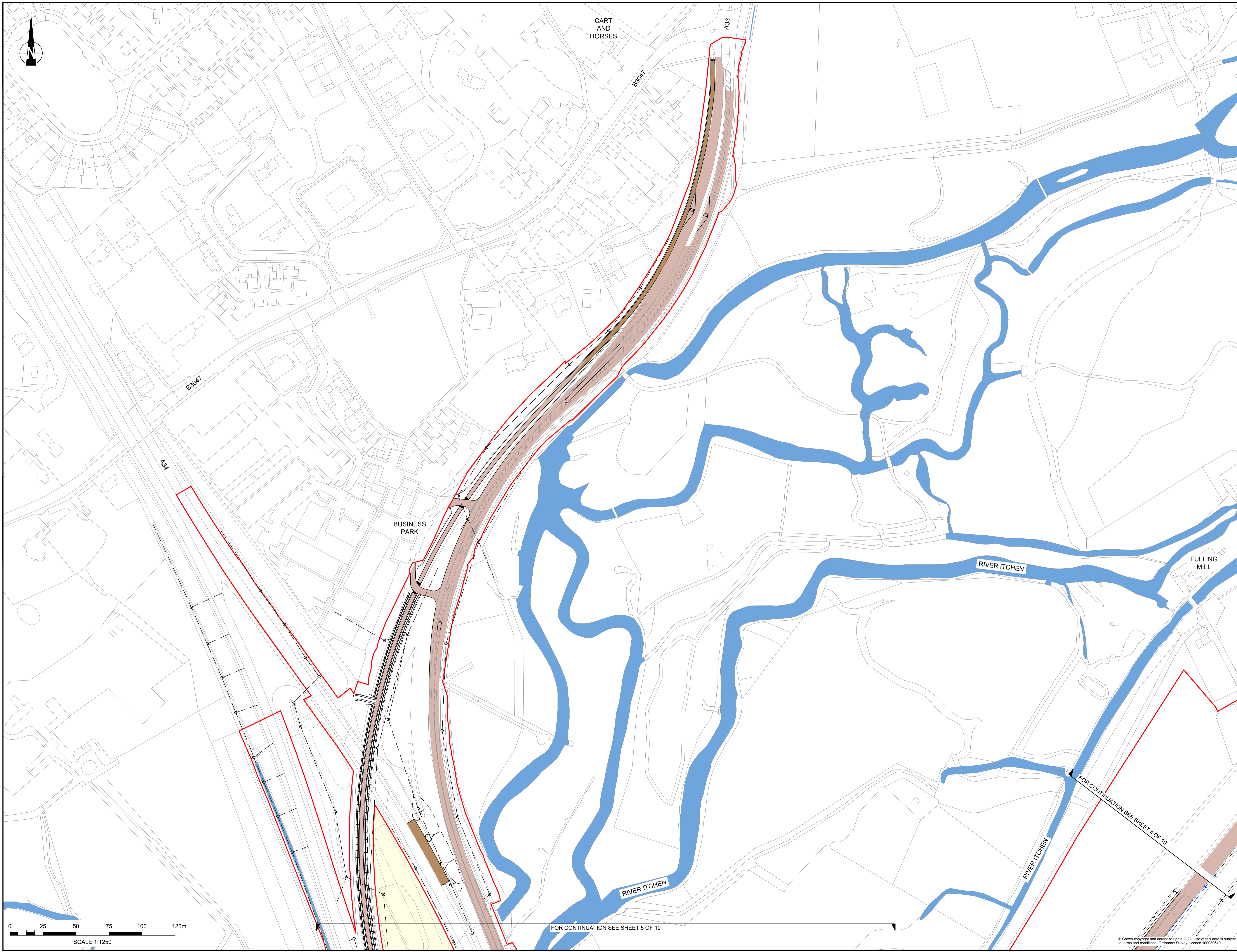

NOTES
 Purpose of use
APPLICATION SUBMISSION
 Development Consent Order Number / Document
TR010055/2.12
 1. THIS DRAWING HAS BEEN PRODUCED USING CAD SOFTWARE. THEREFORE ALL DIMENSIONS ARE SHOWN IN METRES UNLESS SHOWN OTHERWISE.
 2. DO NOT SCALE FROM THIS DRAWING. USE ONLY PRINTED DIMENSIONS.
 3. THE DESIGN SHOWN WILL BE SUBJECT TO DETAILED DESIGN DEVELOPMENT IN ACCORDANCE WITH THE PROVISIONS OF THE DEVELOPMENT CONSENT ORDER.

- KEY TO SYMBOLS
- DEVELOPMENT CONSENT ORDER BOUNDARY
 - LAND NOT INCLUDED IN ORDER LIMITS
 - PROPOSED ROAD MARKINGS
 - PROPOSED HIGHWAY DRAINAGE NETWORK
 - RETAINED EXISTING DRAINAGE
 - RIVER ITCHEN
 - PROPOSED SURFACE WATER GEOCELLULAR ATTENUATION
 - PROPOSED SURFACE WATER INFILTRATION BASIN
 - PROPOSED SURFACE WATER LINED BASIN
 - PROPOSED SURFACE WATER SWALE
 - PROPOSED AREA OF NEW CARRIAGEWAY
 - RETAINED EXISTING CARRIAGEWAY AND ASSOCIATED DRAINAGE FEATURES
 - ∩ PROPOSED SURFACE WATER HEADWALL / OUTFALL
 - PS PROPOSED SURFACE WATER PENSTOCK
 - PROPOSED SURFACE WATER SEDIMENT FOREBAY
 - EXISTING SURFACE WATER SOAKAWAY FEATURE TO BE REFURBISHED AND REUSED
 - FC PROPOSED SURFACE WATER FLOW CONTROL MANHOLE
 - ∨ PROPOSED GRASSED BASINS
 - x-x- EXISTING INFILTRATION FEATURE TO BE ABANDONED

NOTE:
 EXACT FORM OF DRAINAGE REQUIRED TO COLLECT SURFACE WATER RUN OFF (E.G. GULLIES, FILTER DRAINS, CONCRETE CHANNELS) WILL BE DETERMINED AT DETAILED DESIGN

01	JUNE 2023	DEADLINE 2	EO	LC	MF
0	NOVEMBER 2022	APPLICATION SUBMISSION	GP	LC	MF
REV	DATE	REVISION NOTE	ORIG	CHKD	APPD

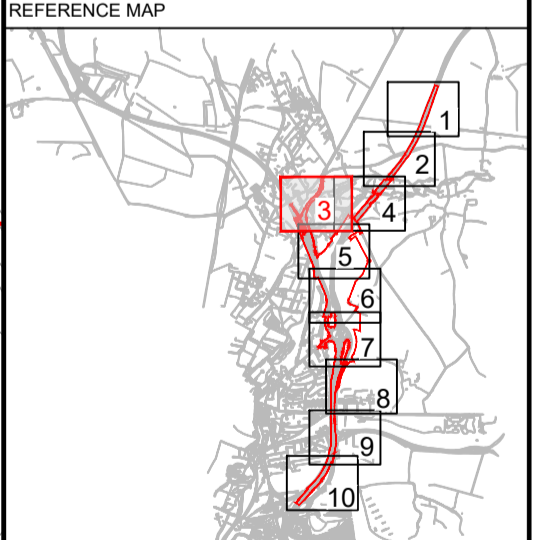

DESIGNER

CONTRACTOR

CLIENT

PROJECT TITLE
 M3 JUNCTION 9 IMPROVEMENT SCHEME

PROJECT STAGE
 PCF STAGE 3

DRAWING TITLE
 DRAINAGE & SURFACE WATER PLANS
 APFP REGULATION s(2)(c)
 SHEET 3 OF 10
 DOCUMENT REFERENCE: 2.12

SUITABILITY
 APPLICATION SUBMISSION

SHEET SIZE: A1 SCALE: 1:1,250 STATUS: REV 01
 DRAWING NUMBER
 HES51511-VFK-LSI-X_XXXX_XX-DR-ZL-7003

FOR CONTINUATION SEE SHEET 5 OF 10

FOR CONTINUATION SEE SHEET 4 OF 10

© Crown copyright and database rights 2022. Use of this data is subject to terms and conditions. Ordnance Survey Licence: 100030449

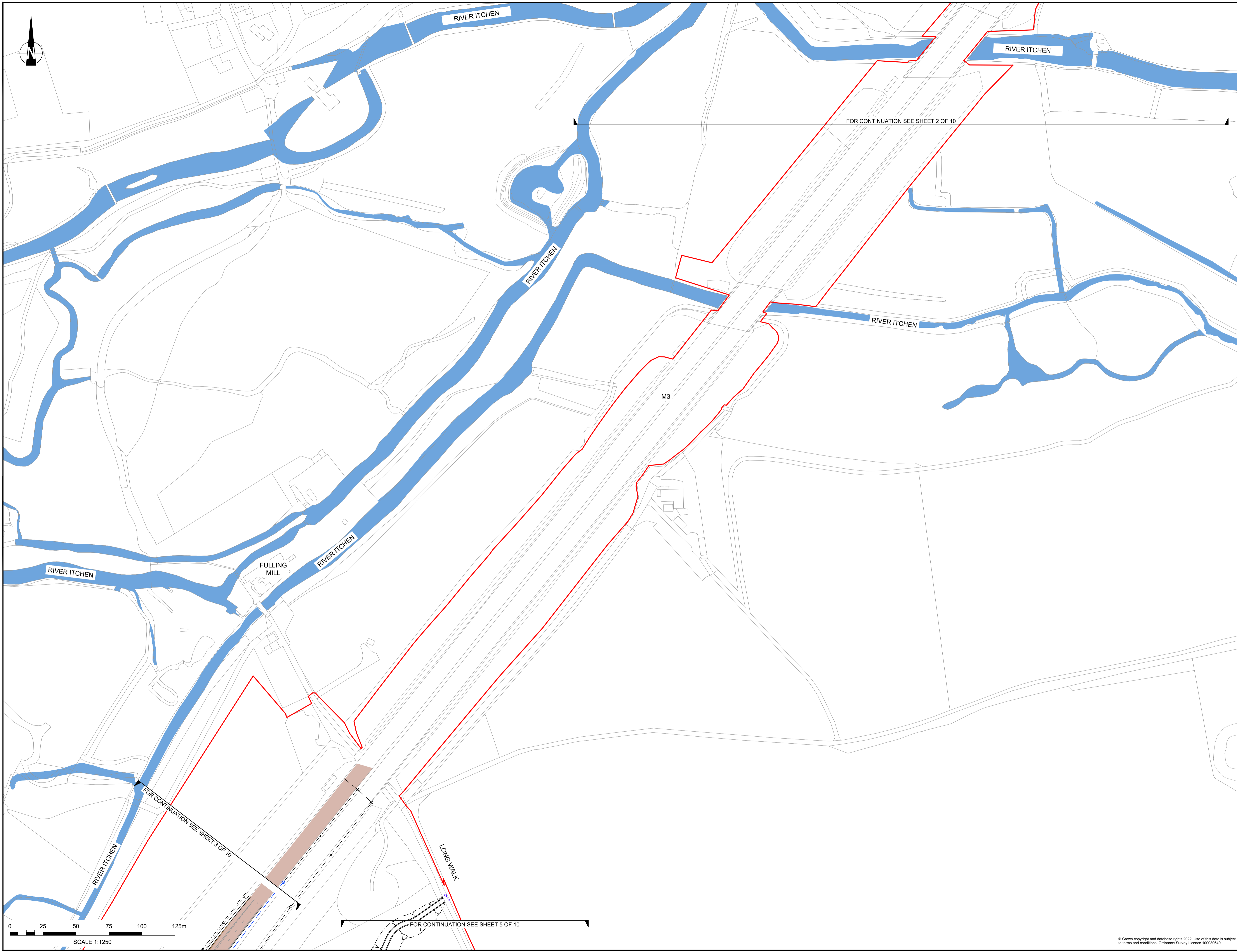

NOTES
 Purpose of use
APPLICATION SUBMISSION
 Development Consent Order Number / Document
TR010055/2.12
 1. THIS DRAWING HAS BEEN PRODUCED USING CAD SOFTWARE. THEREFORE ALL DIMENSIONS ARE SHOWN IN METRES UNLESS SHOWN OTHERWISE.
 2. DO NOT SCALE FROM THIS DRAWING. USE ONLY PRINTED DIMENSIONS.
 3. THE DESIGN SHOWN WILL BE SUBJECT TO DETAILED DESIGN DEVELOPMENT IN ACCORDANCE WITH THE PROVISIONS OF THE DEVELOPMENT CONSENT ORDER.

- KEY TO SYMBOLS
- DEVELOPMENT CONSENT ORDER BOUNDARY
 - LAND NOT INCLUDED IN ORDER LIMITS
 - PROPOSED ROAD MARKINGS
 - PROPOSED HIGHWAY DRAINAGE NETWORK
 - RETAINED EXISTING DRAINAGE
 - RIVER ITCHEN
 - PROPOSED SURFACE WATER GEOCELLULAR ATTENUATION
 - PROPOSED SURFACE WATER INFILTRATION BASIN
 - PROPOSED SURFACE WATER LINED BASIN
 - PROPOSED SURFACE WATER SWALE
 - PROPOSED AREA OF NEW CARRIAGEWAY
 - RETAINED EXISTING CARRIAGEWAY AND ASSOCIATED DRAINAGE FEATURES
 - ∩ PROPOSED SURFACE WATER HEADWALL / OUTFALL
 - PS PROPOSED SURFACE WATER PENSTOCK
 - PROPOSED SURFACE WATER SEDIMENT FOREBAY
 - EXISTING SURFACE WATER SOAKAWAY FEATURE TO BE REFURBISHED AND REUSED
 - PROPOSED SURFACE WATER FLOW CONTROL MANHOLE
 - ∨ PROPOSED GRASSED BASINS
 - x-x- EXISTING INFILTRATION FEATURE TO BE ABANDONED

NOTE:
 EXACT FORM OF DRAINAGE REQUIRED TO COLLECT SURFACE WATER RUN OFF (E.G. GULLIES, FILTER DRAINS, CONCRETE CHANNELS) WILL BE DETERMINED AT DETAILED DESIGN

01	JUNE 2023	DEADLINE 2	EO	LC	MF
0	NOVEMBER 2022	APPLICATION SUBMISSION	GP	LC	MF
REV	DATE	REVISION NOTE	ORIG	CHKD	APPD

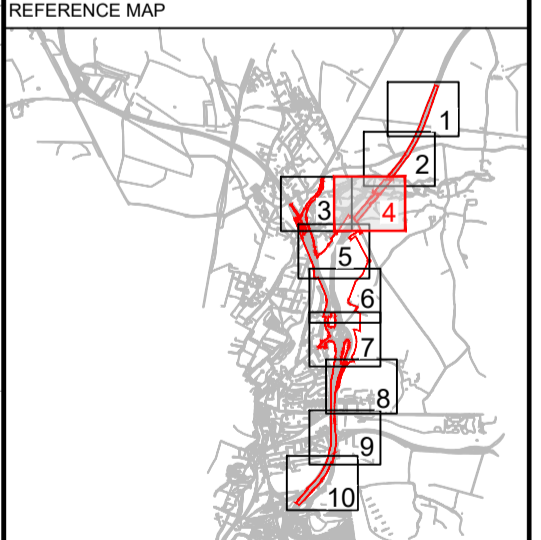

DESIGNER

CONTRACTOR

CLIENT

PROJECT TITLE
 M3 JUNCTION 9 IMPROVEMENT SCHEME

PROJECT STAGE
 PCF STAGE 3

DRAWING TITLE
 DRAINAGE & SURFACE WATER PLANS
 APPP REGULATION s(2)(c)
 SHEET 4 OF 10
 DOCUMENT REFERENCE: 2.12

SUITABILITY
 APPLICATION SUBMISSION

SHEET SIZE: A1 SCALE: 1:1250 STATUS: REV 01
 DRAWING NUMBER
 HES51511-VFK-LSI-X_XXXX_XX-DR-ZL-7004

© Crown copyright and database rights 2022. Use of this data is subject to terms and conditions. Ordnance Survey Licence: 100030649

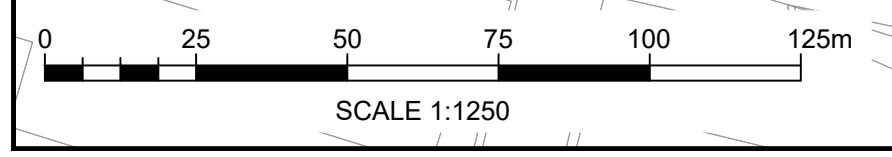
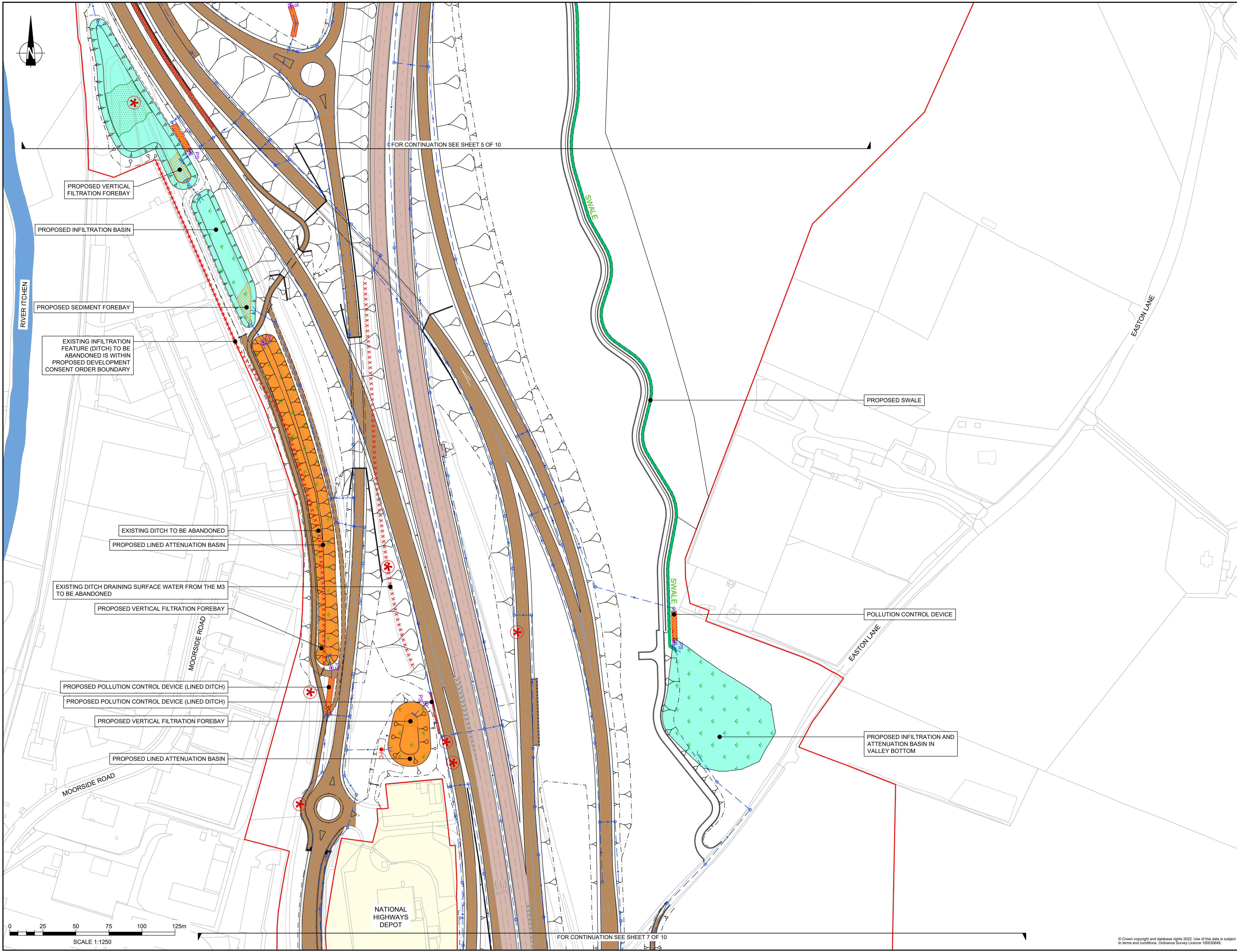

NOTES

Purpose of use
APPLICATION SUBMISSION
 Development Consent Order Number / Document
 TR010055/2.12

1. THIS DRAWING HAS BEEN PRODUCED USING CAD SOFTWARE. THEREFORE ALL DIMENSIONS ARE SHOWN IN METRES UNLESS SHOWN OTHERWISE.
 2. DO NOT SCALE FROM THIS DRAWING. USE ONLY PRINTED DIMENSIONS.
 3. THE DESIGN SHOWN WILL BE SUBJECT TO DETAILED DESIGN DEVELOPMENT IN ACCORDANCE WITH THE PROVISIONS OF THE DEVELOPMENT CONSENT ORDER.

- KEY TO SYMBOLS
- DEVELOPMENT CONSENT ORDER BOUNDARY
 - LAND NOT INCLUDED IN ORDER LIMITS
 - PROPOSED ROAD MARKINGS
 - PROPOSED HIGHWAY DRAINAGE NETWORK
 - RETAINED EXISTING DRAINAGE
 - RIVER ITCHEN
 - PROPOSED SURFACE WATER GEOCELLULAR ATTENUATION
 - PROPOSED SURFACE WATER INFILTRATION BASIN
 - PROPOSED SURFACE WATER LINED BASIN
 - PROPOSED SURFACE WATER SWALE
 - PROPOSED AREA OF NEW CARRIAGEWAY
 - RETAINED EXISTING CARRIAGEWAY AND ASSOCIATED DRAINAGE FEATURES
 - PROPOSED SURFACE WATER HEADWALL / OUTFALL
 - PROPOSED SURFACE WATER PENSTOCK
 - PROPOSED SURFACE WATER SEDIMENT FOREBAY
 - EXISTING SURFACE WATER SOAKAWAY FEATURE TO BE REFURBISHED AND REUSED
 - PROPOSED SURFACE WATER FLOW CONTROL MANHOLE
 - PROPOSED GRASSED BASINS
 - EXISTING INFILTRATION FEATURE TO BE ABANDONED

NOTE:
 EXACT FORM OF DRAINAGE REQUIRED TO COLLECT SURFACE WATER RUN OFF (E.G. GULLIES, FILTER DRAINS, CONCRETE CHANNELS) WILL BE DETERMINED AT DETAILED DESIGN

01	JUNE 2023	DEADLINE 2	EO	LC	MF
0	NOVEMBER 2022	APPLICATION SUBMISSION	GP	LC	MF
REV	DATE	REVISION NOTE	ORIG	CHKD	APPD

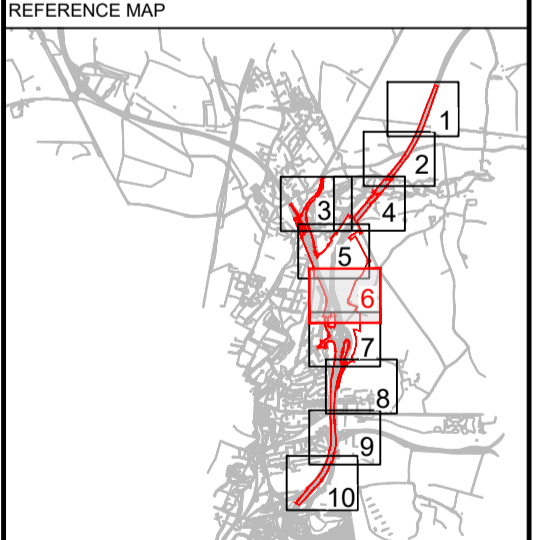

DESIGNER

CONTRACTOR

CLIENT

PROJECT TITLE
 M3 JUNCTION 9 IMPROVEMENT SCHEME

PROJECT STAGE
 PCF STAGE 3

DRAWING TITLE
 DRAINAGE & SURFACE WATER PLANS
 APPP REGULATION s(2)(c)
 SHEET 6 OF 10
 DOCUMENT REFERENCE: 2.12

SUITABILITY
 APPLICATION SUBMISSION

SHEET SIZE: A1 SCALE: 1:1250 STATUS: REV 01
 DRAWING NUMBER
 HES51511-VFK-LSI-X_XXXX_XX-DR-ZL-7006

© Crown copyright and database rights 2022. Use of this data is subject to terms and conditions. Ordnance Survey Licence 100030649

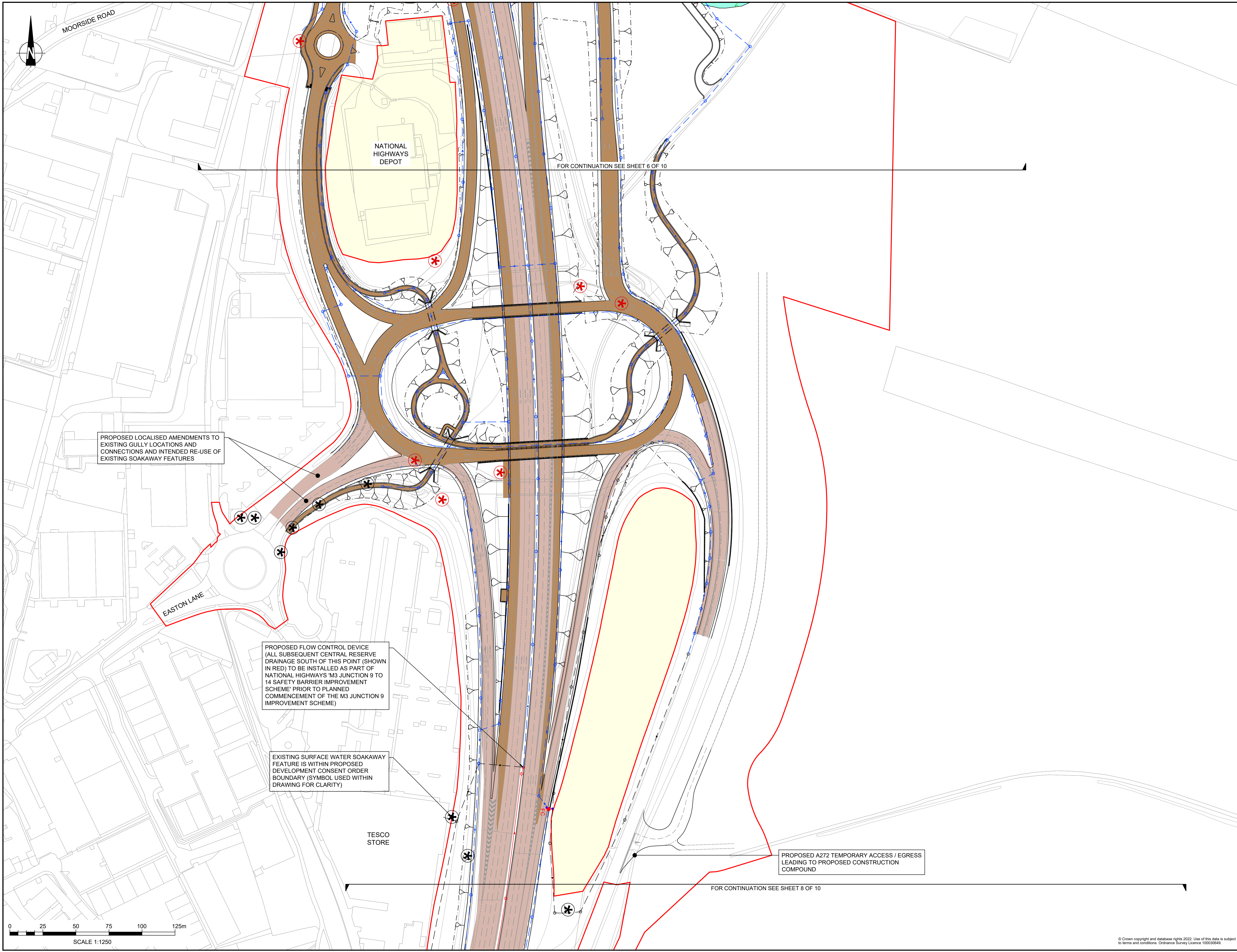

FOR CONTINUATION SEE SHEET 6 OF 10

FOR CONTINUATION SEE SHEET 8 OF 10

PROPOSED LOCALISED AMENDMENTS TO EXISTING GULLY LOCATIONS AND CONNECTIONS AND INTENDED RE-USE OF EXISTING SOAKAWAY FEATURES

PROPOSED FLOW CONTROL DEVICE (ALL SUBSEQUENT CENTRAL RESERVE DRAINAGE SOUTH OF THIS POINT (SHOWN IN RED) TO BE INSTALLED AS PART OF NATIONAL HIGHWAYS 'M3 JUNCTION 9 TO 14 SAFETY BARRIER IMPROVEMENT SCHEME' PRIOR TO PLANNED COMMENCEMENT OF THE M3 JUNCTION 9 IMPROVEMENT SCHEME)

EXISTING SURFACE WATER SOAKAWAY FEATURE IS WITHIN PROPOSED DEVELOPMENT CONSENT ORDER BOUNDARY (SYMBOL USED WITHIN DRAWING FOR CLARITY)

PROPOSED A272 TEMPORARY ACCESS / EGRESS LEADING TO PROPOSED CONSTRUCTION COMPOUND

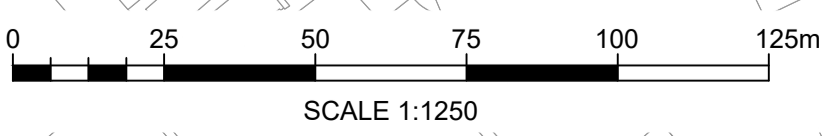

NOTES
 Purpose of use
APPLICATION SUBMISSION
 Development Consent Order Number / Document
 TR010055/2.12

- KEY TO SYMBOLS
- DEVELOPMENT CONSENT ORDER BOUNDARY
 - LAND NOT INCLUDED IN ORDER LIMITS
 - PROPOSED ROAD MARKINGS
 - PROPOSED HIGHWAY DRAINAGE NETWORK
 - RETAINED EXISTING DRAINAGE
 - RIVER ITCHEN
 - PROPOSED SURFACE WATER GEOCELLULAR ATTENUATION
 - PROPOSED SURFACE WATER INFILTRATION BASIN
 - PROPOSED SURFACE WATER LINED BASIN
 - PROPOSED SURFACE WATER SWALE
 - PROPOSED AREA OF NEW CARRIAGEWAY
 - RETAINED EXISTING CARRIAGEWAY AND ASSOCIATED DRAINAGE FEATURES
 - PROPOSED SURFACE WATER HEADWALL / OUTFALL
 - PROPOSED SURFACE WATER PENSTOCK
 - PROPOSED SURFACE WATER SEDIMENT FOREBAY
 - EXISTING SURFACE WATER SOAKAWAY FEATURE TO BE REFURBISHED AND REUSED
 - PROPOSED SURFACE WATER FLOW CONTROL MANHOLE
 - PROPOSED GRASSED BASINS
 - EXISTING INFILTRATION FEATURE TO BE ABANDONED

NOTE:
 EXACT FORM OF DRAINAGE REQUIRED TO COLLECT SURFACE WATER RUN OFF (E.G. GULLIES, FILTER DRAINS, CONCRETE CHANNELS) WILL BE DETERMINED AT DETAILED DESIGN

01	JUNE 2023	DEADLINE 2	EO	LC	MF
0	NOVEMBER 2022	APPLICATION SUBMISSION	GP	LC	MF
REV	DATE	REVISION NOTE	ORIG	CHKD	APPD

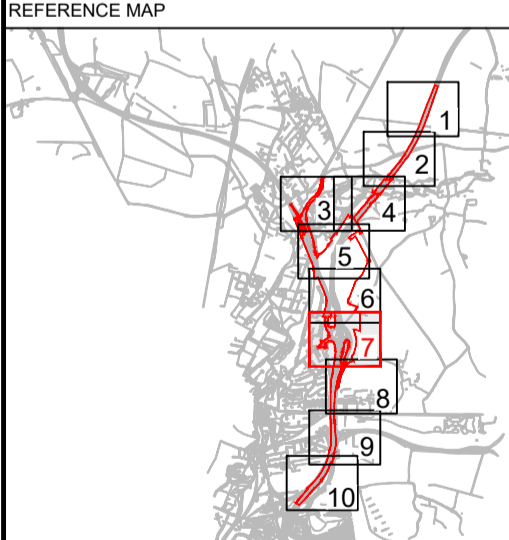

DESIGNER

CONTRACTOR

CLIENT

PROJECT TITLE
 M3 JUNCTION 9 IMPROVEMENT SCHEME

PROJECT STAGE
 PCF STAGE 3

DRAWING TITLE
 DRAINAGE & SURFACE WATER PLANS
 APPFP REGULATION s(2)(o)
 SHEET 7 OF 10
 DOCUMENT REFERENCE: 2.12

SUITABILITY
 APPLICATION SUBMISSION
 SHEET SIZE: A1 SCALE: 1:1,250 STATUS: REV 01
 DRAWING NUMBER
 HES51511-VFK-LSI-X_XXXX_XX-DR-ZL-7007

© Crown copyright and database rights 2022. Use of this data is subject to terms and conditions. Ordnance Survey Licence 100030649



NOTES
 Purpose of use
APPLICATION SUBMISSION
 Development Consent Order Number / Document
 TR010055/2.12

1. THIS DRAWING HAS BEEN PRODUCED USING CAD SOFTWARE. THEREFORE ALL DIMENSIONS ARE SHOWN IN METRES UNLESS SHOWN OTHERWISE.
 2. DO NOT SCALE FROM THIS DRAWING. USE ONLY PRINTED DIMENSIONS.
 3. THE DESIGN SHOWN WILL BE SUBJECT TO DETAILED DESIGN DEVELOPMENT IN ACCORDANCE WITH THE PROVISIONS OF THE DEVELOPMENT CONSENT ORDER.

- KEY TO SYMBOLS
- DEVELOPMENT CONSENT ORDER BOUNDARY
 - LAND NOT INCLUDED IN ORDER LIMITS
 - PROPOSED ROAD MARKINGS
 - PROPOSED HIGHWAY DRAINAGE NETWORK
 - RETAINED EXISTING DRAINAGE
 - RIVER ITCHEN
 - PROPOSED SURFACE WATER GEOCELLULAR ATTENUATION
 - PROPOSED SURFACE WATER INFILTRATION BASIN
 - PROPOSED SURFACE WATER LINED BASIN
 - PROPOSED SURFACE WATER SWALE
 - PROPOSED AREA OF NEW CARRIAGEWAY
 - RETAINED EXISTING CARRIAGEWAY AND ASSOCIATED DRAINAGE FEATURES
 - U PROPOSED SURFACE WATER HEADWALL / OUTFALL
 - PS PROPOSED SURFACE WATER PENSTOCK
 - PROPOSED SURFACE WATER SEDIMENT FOREBAY
 - ⊗ EXISTING SURFACE WATER SOAKAWAY FEATURE TO BE REFURBISHED AND REUSED
 - FC PROPOSED SURFACE WATER FLOW CONTROL MANHOLE
 - ∨ PROPOSED GRASSED BASINS
 - X-X- EXISTING INFILTRATION FEATURE TO BE ABANDONED

NOTE:
 EXACT FORM OF DRAINAGE REQUIRED TO COLLECT SURFACE WATER RUN OFF (E.G. GULLIES, FILTER DRAINS, CONCRETE CHANNELS) WILL BE DETERMINED AT DETAILED DESIGN

01	JUNE 2023	DEADLINE 2	EO	LC	MF
0	NOVEMBER 2022	APPLICATION SUBMISSION	GP	LC	MF
REV	DATE	REVISION NOTE	ORIG	CHKD	APPD

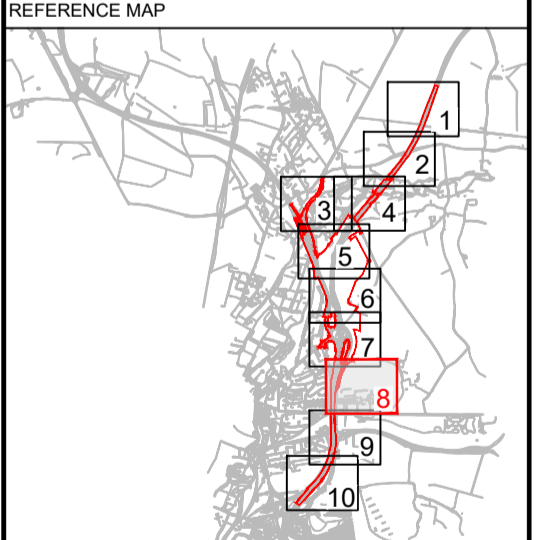

DESIGNER

CONTRACTOR

CLIENT

PROJECT TITLE
 M3 JUNCTION 9 IMPROVEMENT SCHEME

PROJECT STAGE
 PCF STAGE 3

DRAWING TITLE
 DRAINAGE & SURFACE WATER PLANS
 APFP REGULATION s(2)(o)
 SHEET 8 OF 10
 DOCUMENT REFERENCE: 2.12

SUITABILITY
 APPLICATION SUBMISSION

SHEET SIZE: A1 SCALE: 1:1250 STATUS: REV 01

DRAWING NUMBER
 HES51511-VFK-LSI-X_XXXX_XX-DR-ZL-7008

© Crown copyright and database rights 2022. Use of this data is subject to terms and conditions. Ordnance Survey Licence 100030449.

NOTES

Purpose of use
APPLICATION SUBMISSION
 Development Consent Order Number / Document
TR010055/2.12

- THIS DRAWING HAS BEEN PRODUCED USING CAD SOFTWARE. THEREFORE ALL DIMENSIONS ARE SHOWN IN METRES UNLESS SHOWN OTHERWISE.
- DO NOT SCALE FROM THIS DRAWING. USE ONLY PRINTED DIMENSIONS.
- THE DESIGN SHOWN WILL BE SUBJECT TO DETAILED DESIGN DEVELOPMENT IN ACCORDANCE WITH THE PROVISIONS OF THE DEVELOPMENT CONSENT ORDER.

- KEY TO SYMBOLS
- DEVELOPMENT CONSENT ORDER BOUNDARY
 - LAND NOT INCLUDED IN ORDER LIMITS
 - PROPOSED ROAD MARKINGS
 - PROPOSED HIGHWAY DRAINAGE NETWORK
 - RETAINED EXISTING DRAINAGE
 - RIVER ITCHEN
 - PROPOSED SURFACE WATER GEOCELLULAR ATTENUATION
 - PROPOSED SURFACE WATER INFILTRATION BASIN
 - PROPOSED SURFACE WATER LINED BASIN
 - PROPOSED SURFACE WATER SWALE
 - PROPOSED AREA OF NEW CARRIAGEWAY
 - RETAINED EXISTING CARRIAGEWAY AND ASSOCIATED DRAINAGE FEATURES
 - PROPOSED SURFACE WATER HEADWALL / OUTFALL
 - PROPOSED SURFACE WATER PENSTOCK
 - PROPOSED SURFACE WATER SEDIMENT FOREBAY
 - EXISTING SURFACE WATER SOAKAWAY FEATURE TO BE REFURBISHED AND REUSED
 - PROPOSED SURFACE WATER FLOW CONTROL MANHOLE
 - PROPOSED GRASSED BASINS
 - EXISTING INFILTRATION FEATURE TO BE ABANDONED

NOTE:
 EXACT FORM OF DRAINAGE REQUIRED TO COLLECT SURFACE WATER RUN OFF (E.G. GULLIES, FILTER DRAINS, CONCRETE CHANNELS) WILL BE DETERMINED AT DETAILED DESIGN

01	JUNE 2023	DEADLINE 2	EO	LC	MF
0	NOVEMBER 2022	APPLICATION SUBMISSION	GP	LC	MF
REV	DATE	REVISION NOTE	ORIG	CHKD	APPD

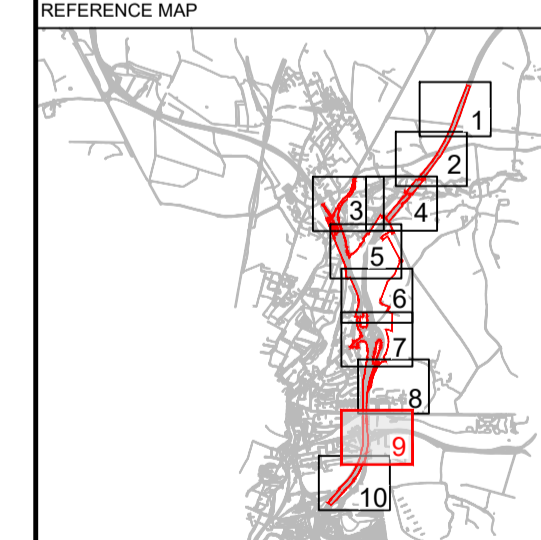

DESIGNER

CONTRACTOR

CLIENT

PROJECT TITLE
M3 JUNCTION 9 IMPROVEMENT SCHEME

PROJECT STAGE
PCF STAGE 3

DRAWING TITLE
**DRAINAGE & SURFACE WATER PLANS
 APPP REGULATION s(2)(c)
 SHEET 9 OF 10
 DOCUMENT REFERENCE: 2.12**

SUITABILITY
APPLICATION SUBMISSION
 SHEET SIZE: A1 | SCALE: 1:1,250 | STATUS: REV 01
 DRAWING NUMBER
 HES51511-VFK-LSI-X_XXXX_XX-DR-ZL-7009

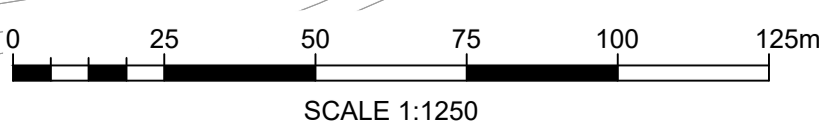
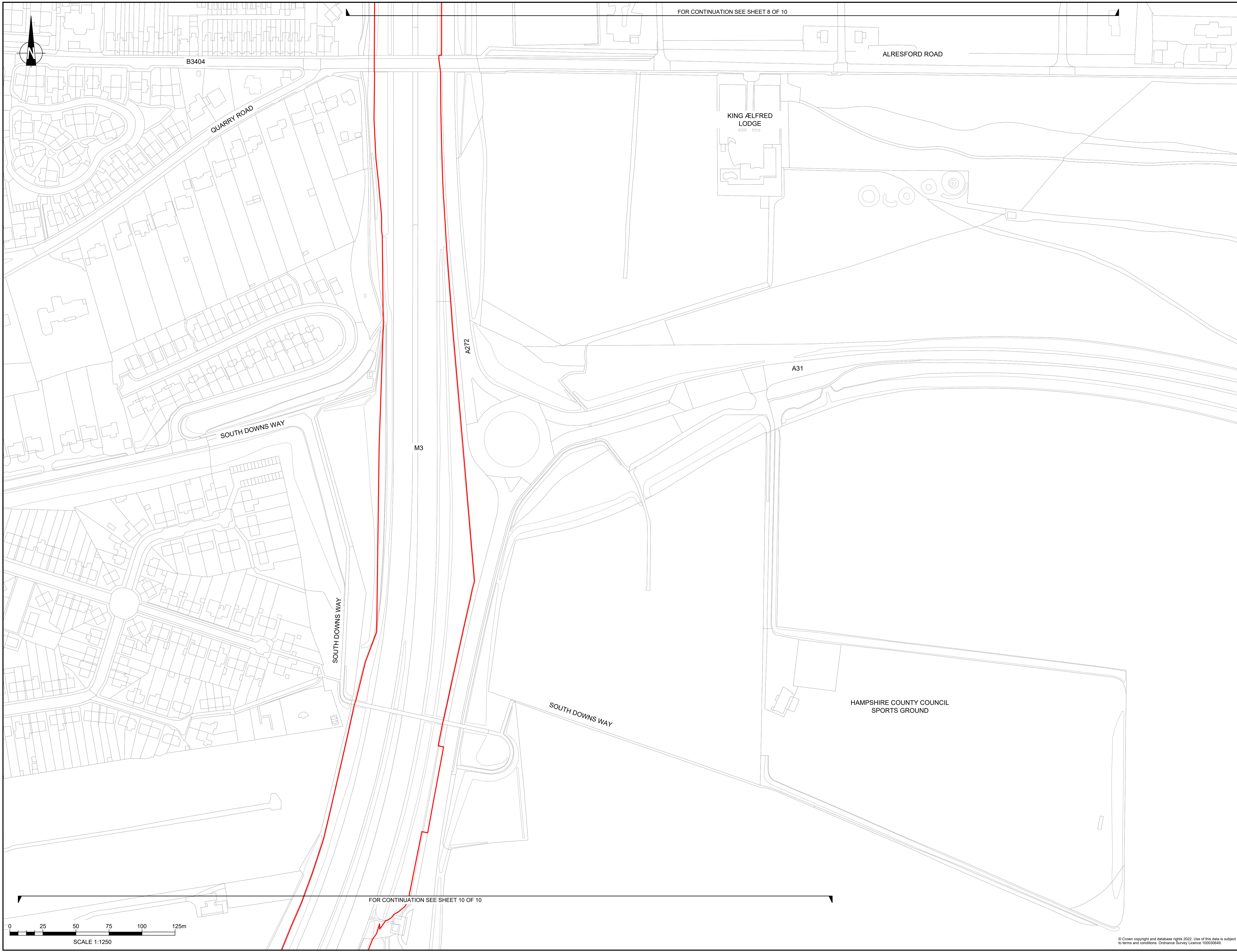

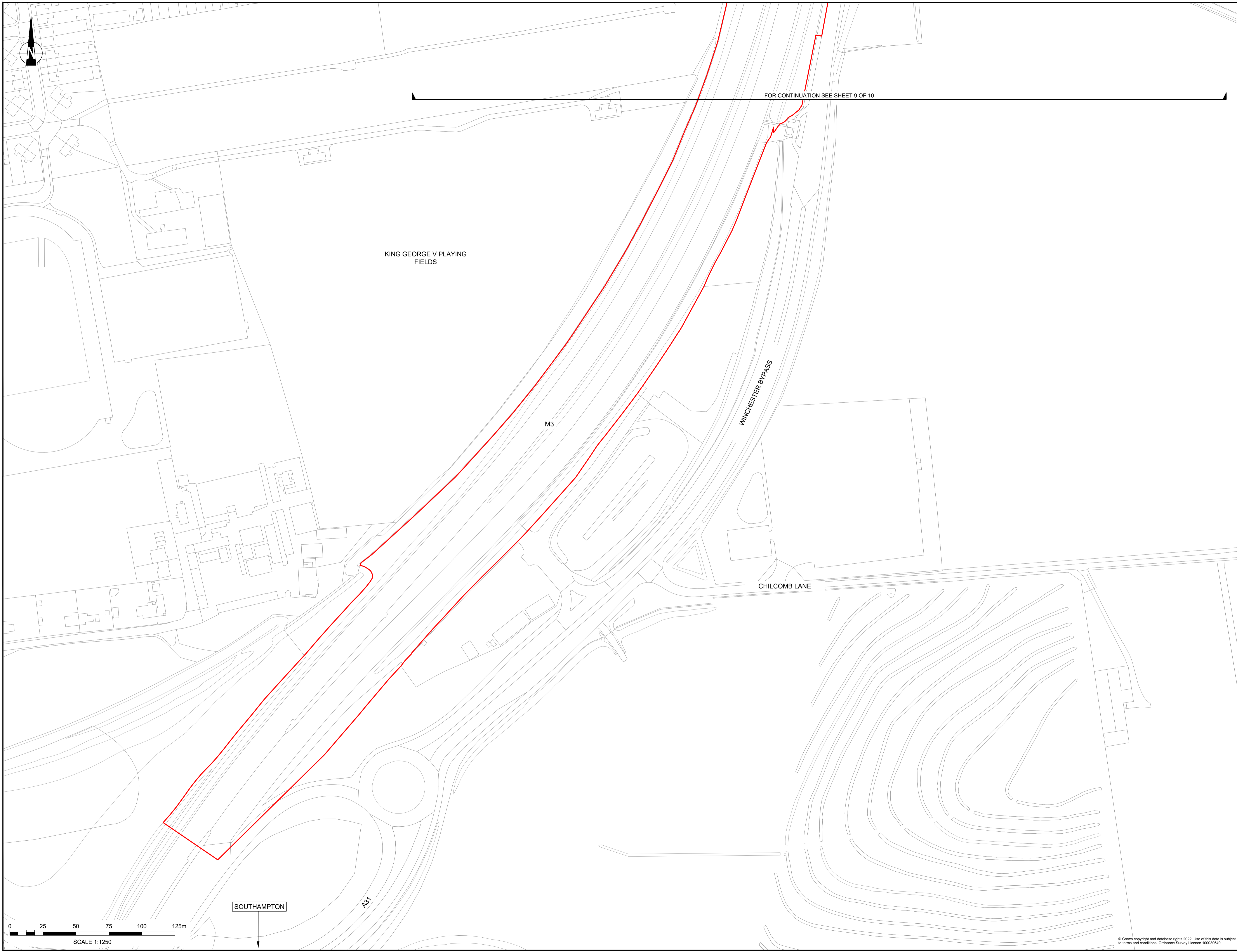

FOR CONTINUATION SEE SHEET 9 OF 10

KING GEORGE V PLAYING FIELDS

WINCHESTER BYPASS

CHILCOMB LANE

SOUTHAMPTON

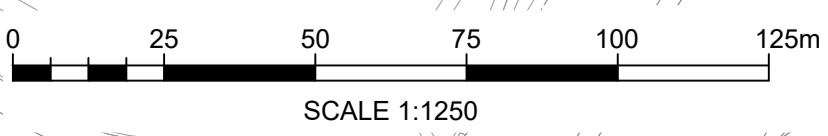

NOTES
 Purpose of use
APPLICATION SUBMISSION
 Development Consent Order Number / Document
TR010055/2.12
 1. THIS DRAWING HAS BEEN PRODUCED USING CAD SOFTWARE. THEREFORE ALL DIMENSIONS ARE SHOWN IN METRES UNLESS SHOWN OTHERWISE.
 2. DO NOT SCALE FROM THIS DRAWING. USE ONLY PRINTED DIMENSIONS.
 3. THE DESIGN SHOWN WILL BE SUBJECT TO DETAILED DESIGN DEVELOPMENT IN ACCORDANCE WITH THE PROVISIONS OF THE DEVELOPMENT CONSENT ORDER.

- KEY TO SYMBOLS
- DEVELOPMENT CONSENT ORDER BOUNDARY
 - LAND NOT INCLUDED IN ORDER LIMITS
 - PROPOSED ROAD MARKINGS
 - PROPOSED HIGHWAY DRAINAGE NETWORK
 - RETAINED EXISTING DRAINAGE
 - RIVER ITCHEN
 - PROPOSED SURFACE WATER GEOCELLULAR ATTENUATION
 - PROPOSED SURFACE WATER INFILTRATION BASIN
 - PROPOSED SURFACE WATER LINED BASIN
 - PROPOSED SURFACE WATER SWALE
 - PROPOSED AREA OF NEW CARRIAGEWAY
 - RETAINED EXISTING CARRIAGEWAY AND ASSOCIATED DRAINAGE FEATURES
 - U PROPOSED SURFACE WATER HEADWALL / OUTFALL
 - PS PROPOSED SURFACE WATER PENSTOCK
 - S PROPOSED SURFACE WATER SEDIMENT FOREBAY
 - S EXISTING SURFACE WATER SOAKAWAY FEATURE TO BE REFURBISHED AND REUSED
 - FC PROPOSED SURFACE WATER FLOW CONTROL MANHOLE
 - G PROPOSED GRASSED BASINS
 - X X X EXISTING INFILTRATION FEATURE TO BE ABANDONED

NOTE:
 EXACT FORM OF DRAINAGE REQUIRED TO COLLECT SURFACE WATER RUN OFF (E.G. GULLIES, FILTER DRAINS, CONCRETE CHANNELS) WILL BE DETERMINED AT DETAILED DESIGN

REV	DATE	REVISION NOTE	ORIG	CHKD	APPD
01	JUNE 2023	DEADLINE 2	EO	LC	MF
0	NOVEMBER 2022	APPLICATION SUBMISSION	GP	LC	MF

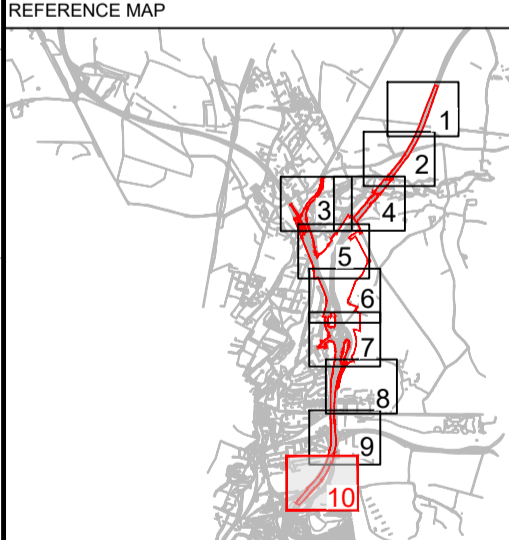

DESIGNER

CONTRACTOR

CLIENT

PROJECT TITLE
M3 JUNCTION 9 IMPROVEMENT SCHEME

PROJECT STAGE
PCF STAGE 3

DRAWING TITLE
**DRAINAGE & SURFACE WATER PLANS
 APFP REGULATION s(2)(a)
 SHEET 10 OF 10
 DOCUMENT REFERENCE: 2.12**

SUITABILITY
APPLICATION SUBMISSION
 SHEET SIZE: A1 | SCALE: 1:1250 | STATUS: REV 01
 DRAWING NUMBER
 HES51511-VFK-LSI-X_XXXX_XX-DR-ZL-7010

© Crown copyright and database rights 2022. Use of this data is subject to terms and conditions. Ordnance Survey Licence 100030649